

THERMOSTAT COMPONENTS

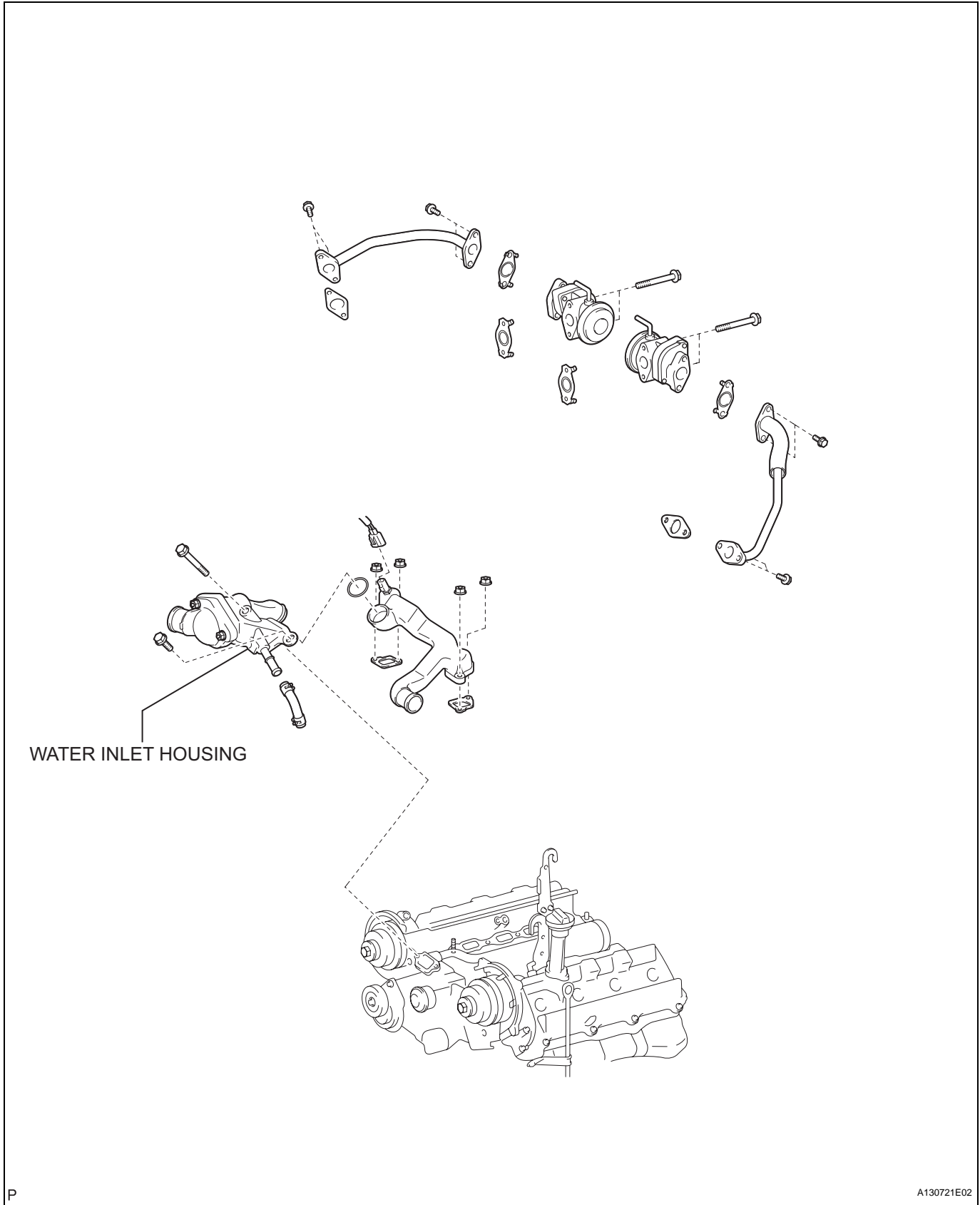

REMOVAL

HINT:

Removal of the thermostat would have an adverse effect, causing a lowering of cooling efficiency. Do not remove the thermostat, even if the engine tends to overheat.

1. DRAIN ENGINE COOLANT (See page CO-3)

2. SEPARATE WATER INLET HOUSING

- (a) Remove the 3 nuts, and separate the water inlet from the water inlet housing.

3. REMOVE THERMOSTAT

- (a) Remove the thermostat.
(b) Remove the gasket from the thermostat.

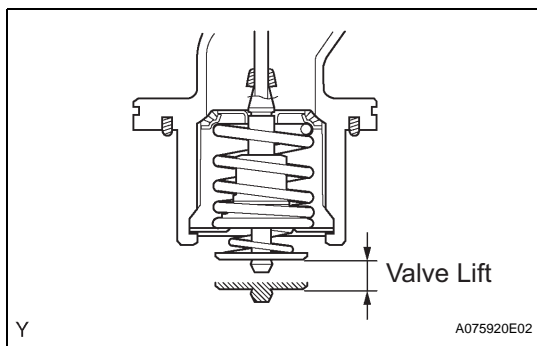
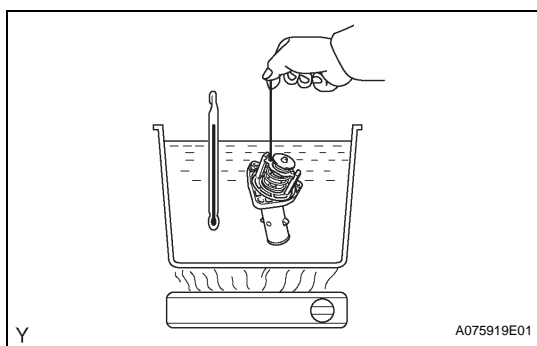
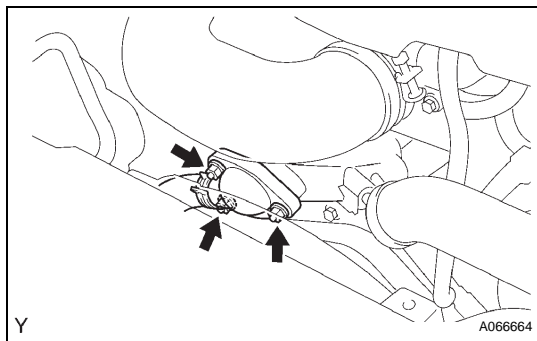

INSPECTION

1. INSPECT WATER INLET WITH THERMOSTAT

HINT:

The valve opening temperature is inscribed on the thermostat.

- (a) Immerse the thermostat in water, then gradually heat the water.
(b) Check the valve opening temperature of the thermostat.

Valve opening temperature:

80 to 84°C (176 to 183°F)

If the valve opening temperature is not as specified, replace the thermostat.

- (c) Check the valve lift.

Valve lift:

8.0 mm (0.31 in.) or more at 95°C (203°F)

If the valve lift is not as specified, replace the thermostat.

- (d) Check that the valve is fully closed when the thermostat is at low temperature (below 40°C (104°F)).

If not fully closed, replace the thermostat.

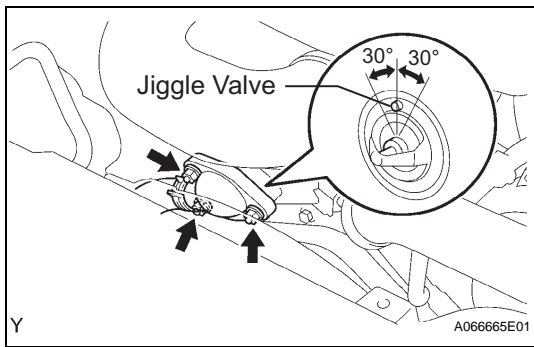

INSTALLATION

1. INSTALL THERMOSTAT

- (a) Install a new gasket to the thermostat.
- (b) Insert the thermostat into the water inlet housing with the jiggle valve facing straight upward.

HINT:

The jiggle valve may be set within 30° of either side of the prescribed position.

2. INSTALL WATER INLET HOUSING

- (a) Install the water inlet with the 3 nuts.

Torque: 19 N*m (195 kgf*cm, 14 ft.*lbf)

3. FILL UP ENGINE COOLANT (See page [CO-3](#))